

How to use the Training Panel

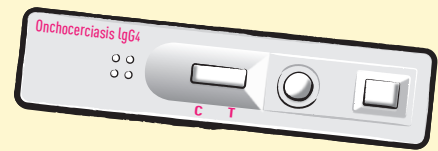

Contents included in the Anti-Ov16 IgG4 Training Panel Q5001:

- 4 panel members with 300 µL of liquid in each vial:
 - Negative
 - Low positive
 - Medium positive
 - High positive
- Anti-Ov16 IgG4 Training Panel Product Insert, Product Number Q5001.

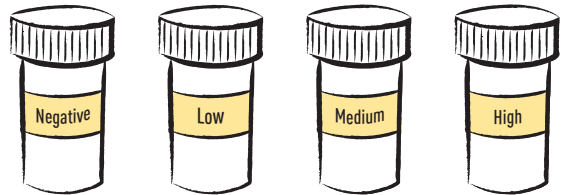

Materials required but not supplied:

- SD BIOLINE Onchocerciasis IgG4 Rapid Test kit
 - 4 rapid tests
 - 4 capillary pipettes
 - Assay diluent from test kit

STEP 1. Each panel member will be run on a separate rapid test.

For each rapid test:

- Check the expiration date on the rapid test pouch. Do not use a rapid test that is expired.
- Check the desiccant packet for yellow and white beads. If it contains any green beads, do not use the test.

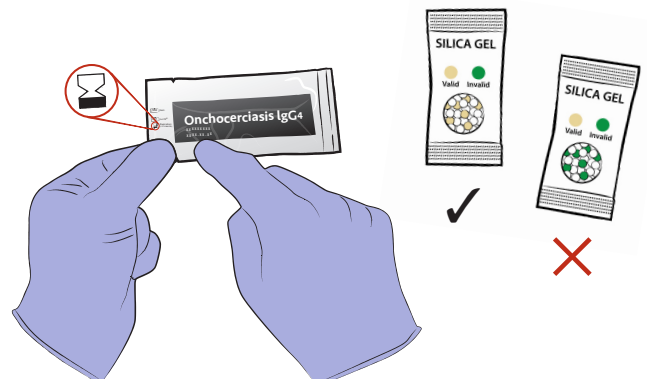

STEP 2. Use a new capillary pipette supplied with the Onchocerciasis IgG4 test kit.

- Squeeze the capillary pipette and place into the panel member that you wish to use. Slowly release the pressure on the capillary pipette to draw up the sample to the line (see images to the right).
- Place the capillary pipette into the **round sample well**. Do not use excessive force. Squeeze gently to release the sample. Let the liquid absorb. Discard the capillary pipette into the sharps container.

Do not reuse capillary pipettes.

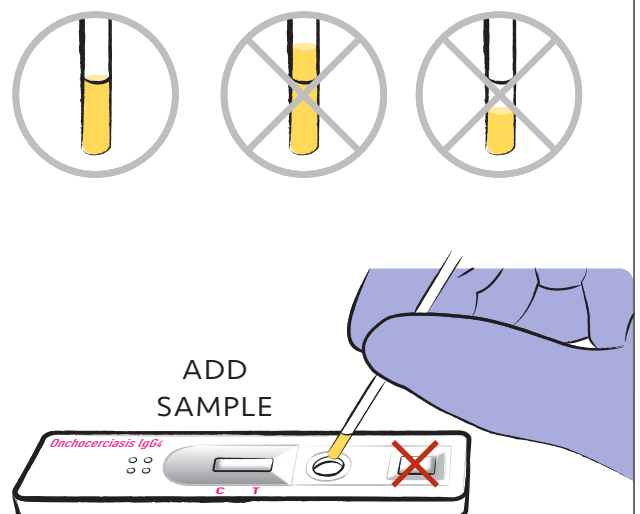

How to use the Training Panel

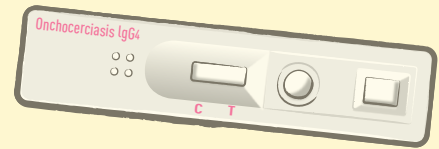

STEP 3. Add **four drops** of the assay diluent supplied with the Onchocerciasis IgG4 test kit into the **square assay diluent well**.
Do not add assay diluent to the round sample well.

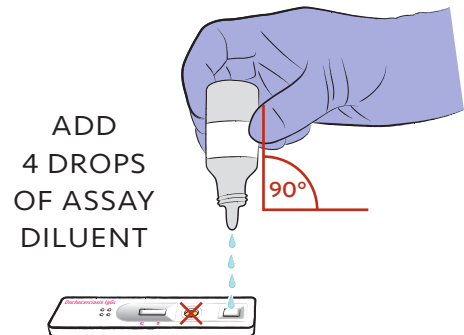

STEP 4. Wait for 30 minutes.



STEP 5. Read the test. Positive test results will have varying degrees of intensity. The negative should not have a visible test line.
Do not read the test after 24 hours.

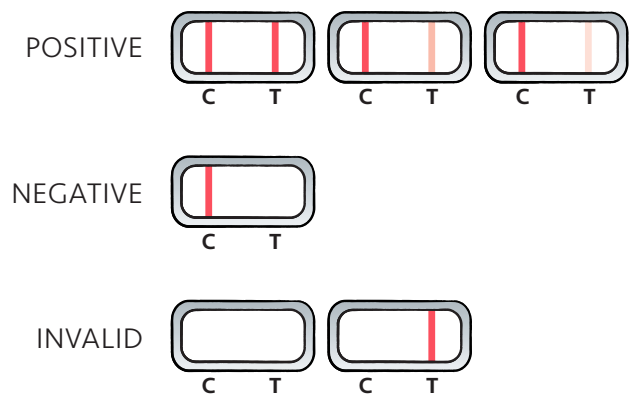

STEP 6. Use the training panel data sheet at the end of these instructions to record the result for each rapid test.
Dispose of used rapid tests in the biohazard waste. Training panel members may be used for up to 2 days and then should be disposed of in the biohazard waste.

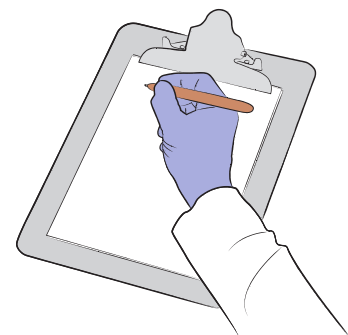

This document must be printed in **color** to be valid.

For more information or training-related questions, contact PATH's Diagnostics Program at dxinfo@path.org.

